

Features SMD Metal-Series

- High reliability
- Small size
- Excellent for automotive applications



HC49S8SMD

Specification

Type	HC49S8SMD	ESR (max.)
Frequency Range fundamental	8,0MHz ~ 50,0MHz (AT cut)	8,0MHz ~ 12,0MHz = 80 Ohm
Frequency Range over tone	-	12,1MHz ~ 16,0MHz = 60 Ohm
Frequency Tolerance at 25°C±5°C	standard ±30ppm; available ±10 ~ ±50ppm	16,1MHz ~ 19,0MHz = 50 Ohm
Temperature Range	0°C ~ +70°C, or order code	19,1MHz ~ 50,0MHz = 40 Ohm
Load Capacitance CL	standard 12pF; available 5pF ~ 50pF, SR	
Shunt Capacitance C0	5pF max.	
Aging	±5ppm/year max	
Storage Temperature	-40°C - +85°C	Temp. Tolerance (ppm)
Drive Level	100uW typ.	-20°C ~ +70°C standard ±30 available ±10 ~ ±50
RoHS	compliant	-40°C ~ +85°C standard ±50 available ±10 ~ ±50
Contents Of Reel	3000 pcs	-40°C ~ +125°C standard ±100 available ±70 ~ ±150

Drawing (mm)

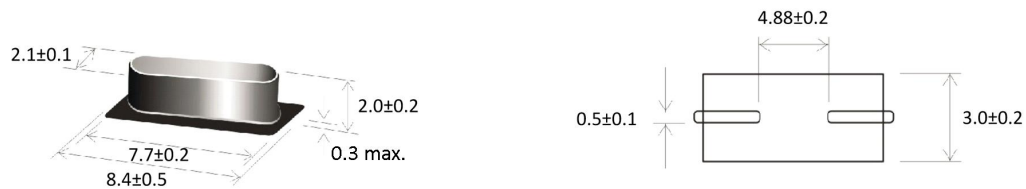

Tape dimension (mm)

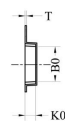
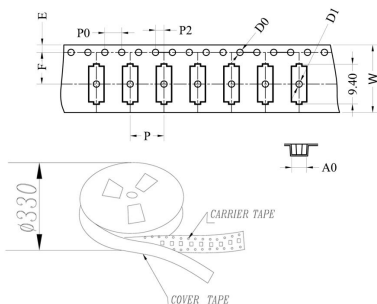

ITEM	DIM
W	16.0±0.30
A ₀	3.50±0.10
B ₀	8.30±0.10
K ₀	2.50±0.10
E	1.75±0.10
F	7.5±0.10
P	8.00±0.10
P ₁	4.00±0.10
P ₂	2.00±0.10
D	Ø1.5 ^{+0.10} / _{-0.00}
D ₁	Ø1.5 ^{+0.10} / _{-0.00}
t	0.35±0.05

package 49S8SMD

Soldering profile

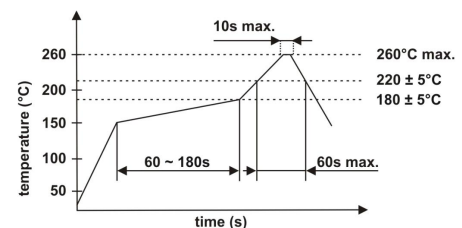

Order code

Q	- 20.000000M	- HC49S8SMD	- F	- 30	- 50	- D	- 12	- TR
Part	Frequency	Package	Mode of oscillation	Frequency tolerance	Temperature tolerance	Temperature range	Load capacitance	Option
Q=Quartz	M=MHz	HC49S8SMD	F=fund.	±ppm (25°C)	±ppm (Temp. range)	B= -10°C ~ +60°C D= -20°C ~ +70°C E= -40°C ~ +85°C F= -40°C ~ +105°C G= -40°C ~ +125°C	12 pF SR=series	TR=Tape and reel X=Special options